

REVERE  
ROUTE 145 OVER MBTA AND B&M RAILROAD

STATE	FED. AID PROJ. NO.	SHEET NO.	TOTAL SHEETS
MASS.	-	44	123
PROJECT FILE NO.		605528	

TEMPORARY TRAFFIC CONTROL PLAN  
DETOUR PLAN  
SHEET 11 OF 11

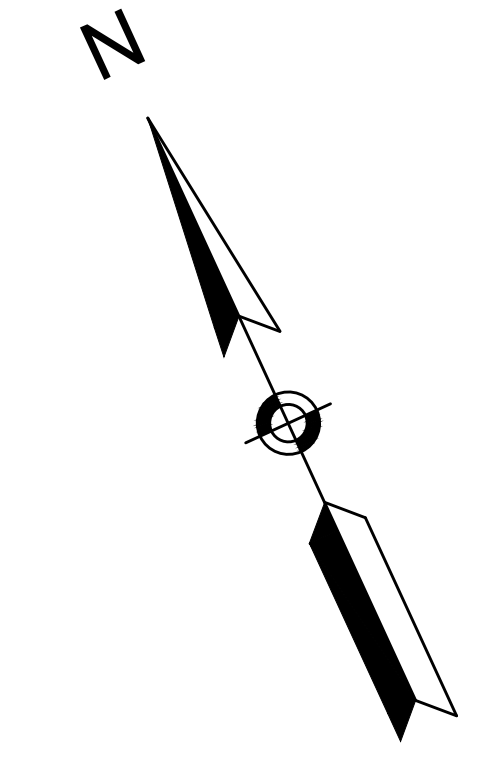

LEGEND

- TEMPORARY SIGN
- TYPE III BARRICADE
- AREA OF ROADWAY CLOSURE
- DETOUR ROUTE
- PORTABLE CHANGEABLE MESSAGE SIGN

CONSTRUCTION NOTES:

1. THE DETOUR PLAN APPLIES TO A 2-DAY WEEKEND PERIOD (8 PM FRIDAY TO 5 AM MONDAY) WHERE THE ROUTE 145 BRIDGE IS CLOSED ALL TRAFFIC IN BOTH DIRECTIONS. THIS DETOUR WILL GO INTO EFFECT FOR TWO WEEKENDS DURING CONSTRUCTION OF THE WESTBOUND BRIDGE AND AN ADDITIONAL TWO WEEKENDS DURING THE CONSTRUCTION OF THE EASTBOUND BRIDGE.
  - DETOUR WEEKEND 1: DEMOLISH THE EXISTING BRIDGE.
  - DETOUR WEEKEND 2: LAUNCH PROPOSED BRIDGE TRUSS INTO FINAL LOCATION AND COMPLETE ROADWAY APPROACH WORK.

2. A PORTABLE CHANGEABLE MESSAGE SIGN SHALL BE PLACED ALONG ROUTE 16 EASTBOUND AS SHOWN ON THE PLAN. THE PORTABLE CHANGEABLE MESSAGE SIGN SHALL HAVE THE FOLLOWING PHASES, AND EACH PHASE SHALL BE DISPLAYED FOR 4 SECONDS. ANY ALTERNATE PHASE MESSAGES SHALL BE APPROVED BY THE RESIDENT ENGINEER.
 

RTE 145 BRIDGE CLOSED	FOLLOW DETOUR SIGNS
-----------------------------	---------------------------

3. DURING CONSTRUCTION STAGES 1B AND 2B, ALL DETOUR SIGNS SHALL BE COVERED OR REMOVED.

## BRIDGE OUT

### 1/2 MILE AHEAD

ROUTE 1A SOUTH ACCESS  
AND LOCAL TRAFFIC ONLY

9.5	29.5	8	15.5	9.5	42
8.2	9.5	6	13.7	6	20.4
6.6	13.1	4	4.3	4	13.3
5.5	8.2	4	13.1	4	17
72					

6.0" Radius, 1.3" Border, Black on White;  
 [BRIDGE OUT] C 85% spacing; [1/2 MILE AHEAD] C 85% spacing;  
 [ROUTE 1A SOUTH ACCESS] C 85% spacing;  
 [AND LOCAL TRAFFIC ONLY] C 85% spacing;

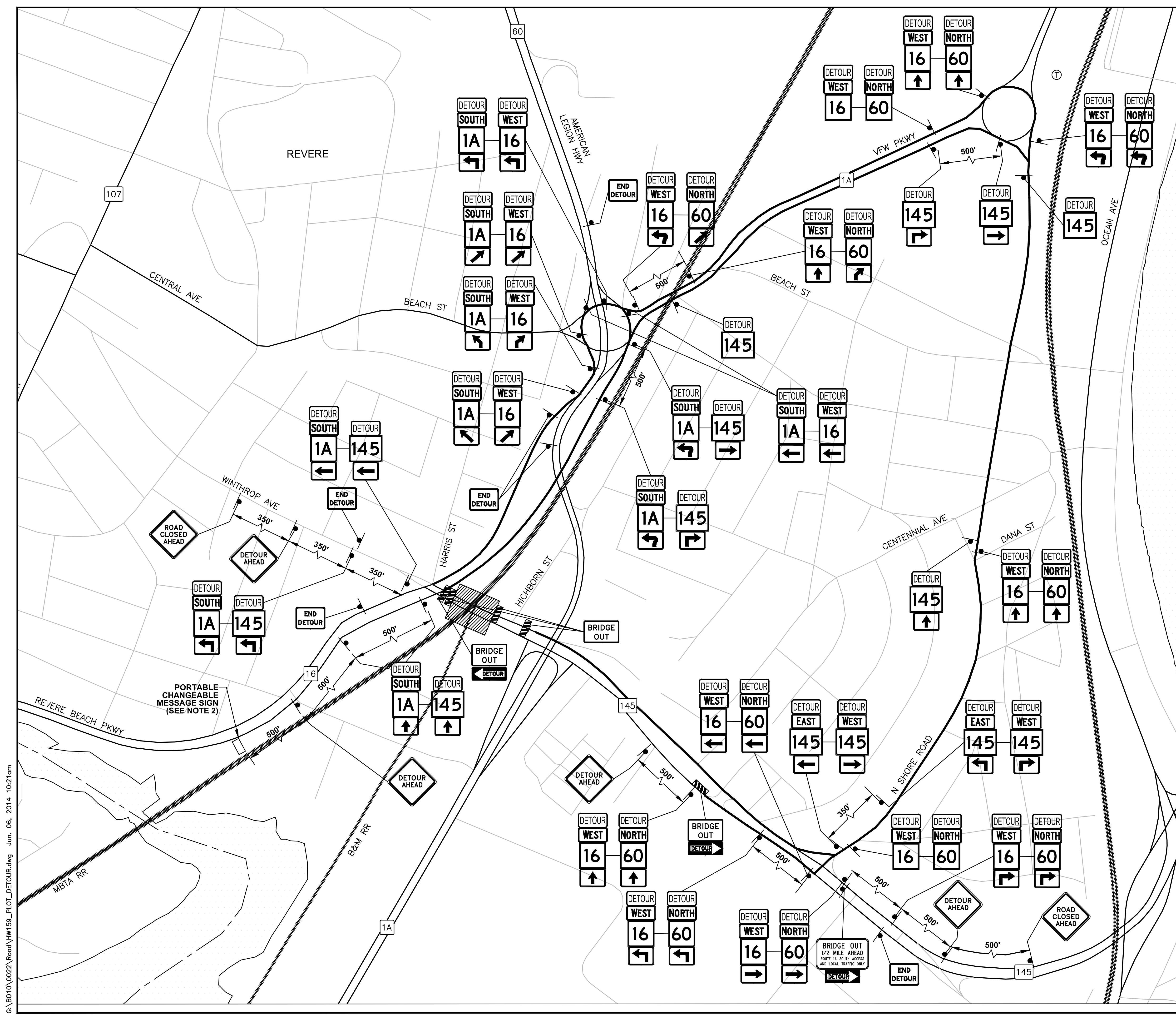

G:\B010\0022\Road\HW159\_PLOT\_DETOUR.dwg Jun. 06. 2014 10:21am